

O:\Planroom\Database\building_Floor_Plans\Plan_Book\Building 172-F_tsitqawi.dwg AutoCAD PDF (High Quality Print).pc3 ANSI full bleed A (8.50 x 11.00 Inches) cpdf.ctb

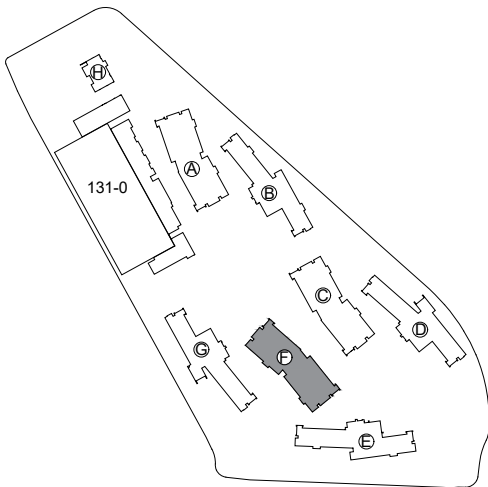

VICINITY MAP



tsitqawi

Floor 1

FACILITIES MANAGEMENT AND DEVELOPMENT

Space Data http://afd.calpoly.edu/facilities/spacefacility/space_data.asp

000 UNASSIGN	400 STUDY	800 HEALTH
100 CLASS	500 SPECIAL	900 RESIDENTIAL
200 LAB	600 GENERAL	
300 OFFICE	700 SUPPORT	

Room Use

March 2022

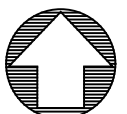

1" = 30'

O:\Planroom\Database\building_Floor_Plans\Plan_Book\Building 172-F_tsitqawi.dwg AutoCAD PDF (High Quality Print).pc3 ANSI full bleed A (8.50 x 11.00 Inches) cpdf.ctb

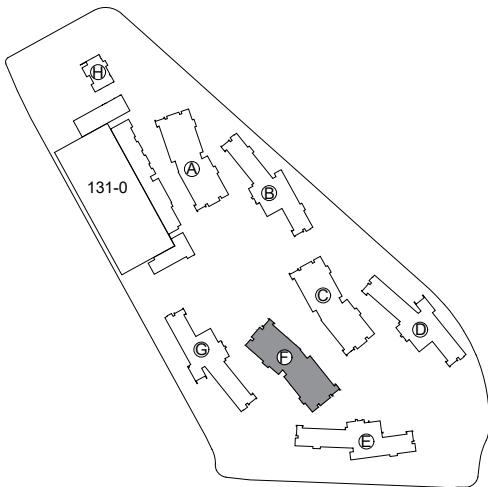

VICINITY MAP



tsitqawi

Floor 2

FACILITIES MANAGEMENT AND DEVELOPMENT

Space Data http://afd.calpoly.edu/facilities/spacefacility/space_data.asp

000 UNASSIGN	400 STUDY	800 HEALTH
100 CLASS	500 SPECIAL	900 RESIDENTIAL
200 LAB	600 GENERAL	
300 OFFICE	700 SUPPORT	

Room Use

March 2022

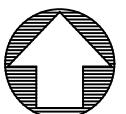

1" = 30'

O:\Planroom\Database\building_Floor_Plans\Plan_Book\Building 172-F_tsitqawi.dwg AutoCAD PDF (High Quality Print).pc3 ANSI full bleed A (8.50 x 11.00 Inches) cpdf.ctb

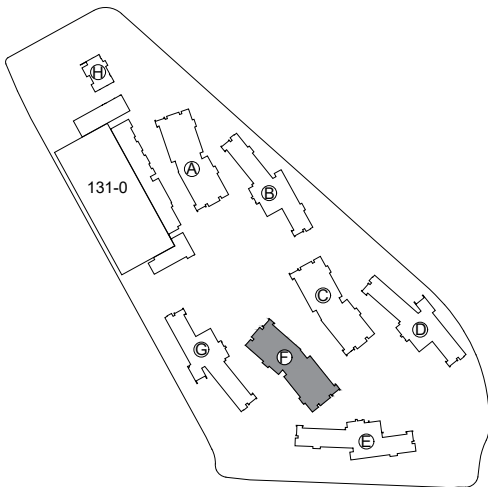
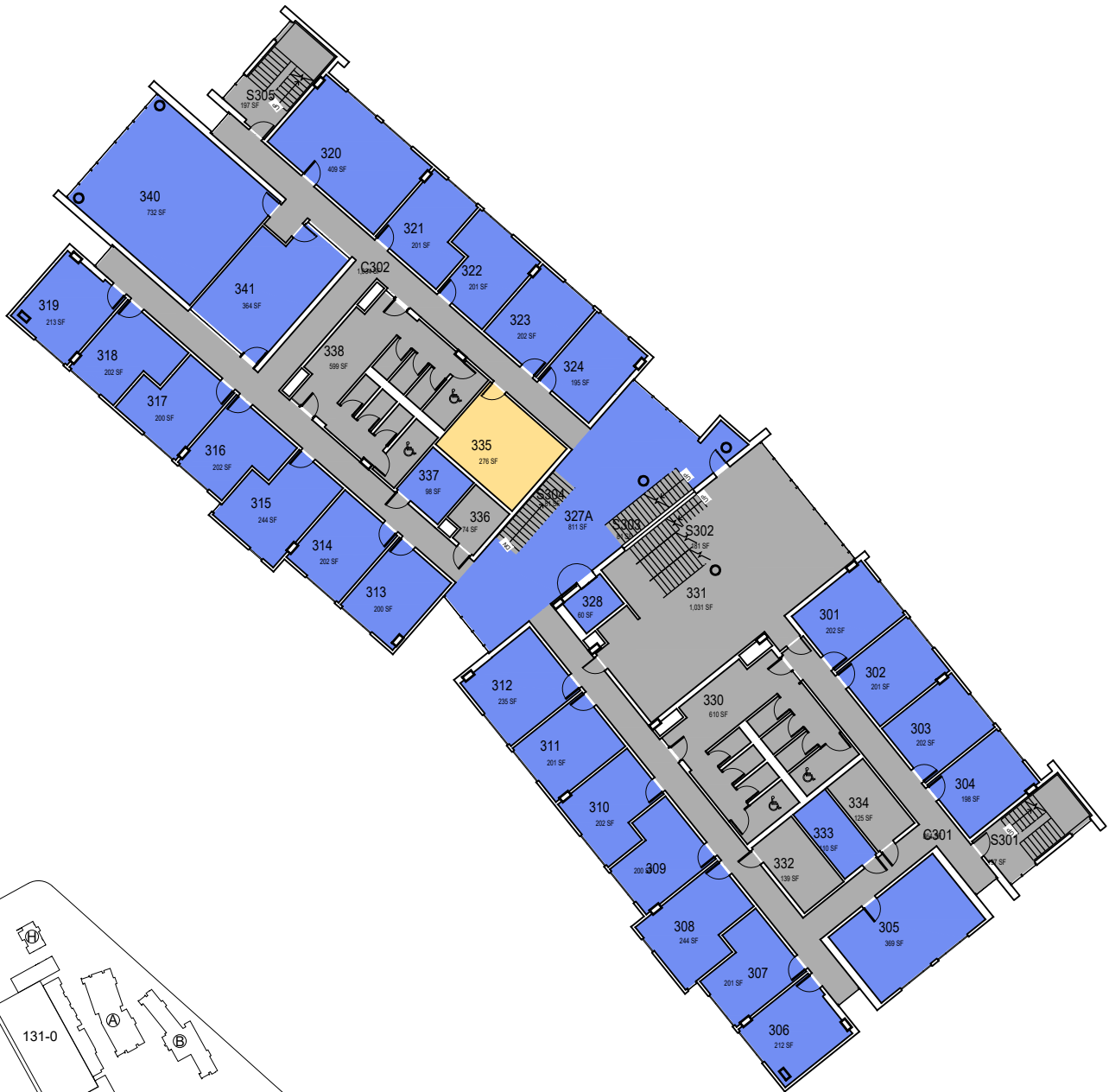

VICINITY MAP



tsitqawi

Floor 3

FACILITIES MANAGEMENT AND DEVELOPMENT

Space Data http://afd.calpoly.edu/facilities/spacefacility/space_data.asp

000 UNASSIGN	400 STUDY	800 HEALTH
100 CLASS	500 SPECIAL	900 RESIDENTIAL
200 LAB	600 GENERAL	
300 OFFICE	700 SUPPORT	

Room Use

March 2022

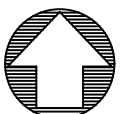

1" = 30'

O:\Planroom\Database\building_Floor_Plans\Plan_Book\Building 172-F_tsitqawi.dwg AutoCAD PDF (High Quality Print).pc3 ANSI full bleed A (8.50 x 11.00 Inches) cpdf.ctb

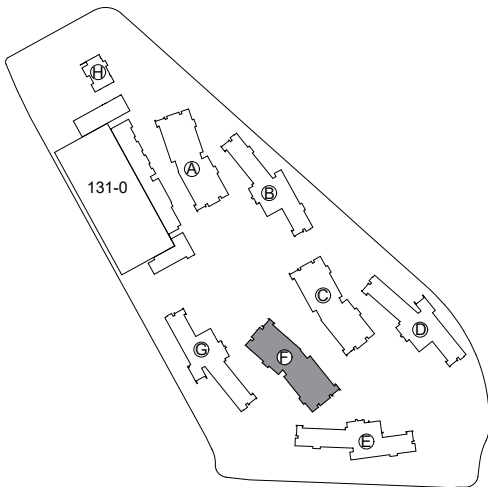

VICINITY MAP



tsitqawi

Floor 4

FACILITIES MANAGEMENT AND DEVELOPMENT

Space Data http://afd.calpoly.edu/facilities/spacefacility/space_data.asp

000 UNASSIGN	400 STUDY	800 HEALTH
100 CLASS	500 SPECIAL	900 RESIDENTIAL
200 LAB	600 GENERAL	
300 OFFICE	700 SUPPORT	

Room Use

March 2022

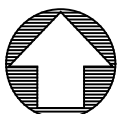

1" = 30'